

**PRODUCT GUIDE 2015**

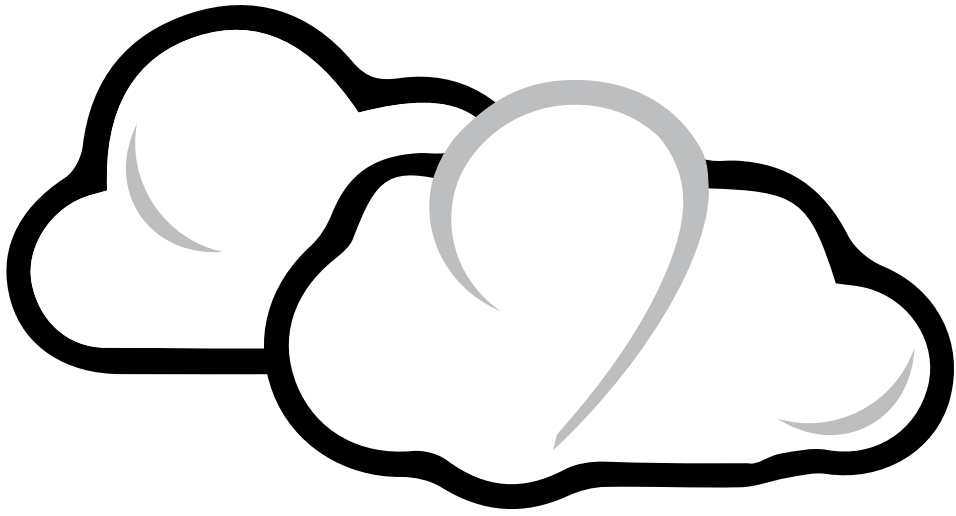

# TABLE OF CONTENTS

	<u>D5 Milan</u>	
	D5 FlatWall	3
	D5 Curve	3
	D5 Arc	4
	D5 Shapes	4
	D5 Table Top	4
<u>Fabric Mural &amp; Pop Up</u>		
	Blizzard	5
	TradeWind	6
	Typhoon	7
<u>Banner Stands</u>		
	Mistral	8
	Sirocco	9
	Zephyr	10
	Alize	11
	Twister S10	12
	Twister S20	13
	Spirit	14
<u>D4 Displays</u>		
	D4 Standard	15
	D4 Wave	15
	D4 Linked	16
<u>Digital &amp; LED Displays</u>		
	Vision Lightscreen	17
	Vision Touchscreen	18
<u>Flags</u>		
	Breeze	19
<u>Counters</u>		
	Demo Counter	20
	D5 Milan Podium	21
	Blizzard Counter	22
<u>Hanging Signs</u>		
	Hanging Signs	23

# D5 MILAN

## A Prestige Backwall System

The D5 Milan is a lightweight modular aluminum frame system that integrates with large format photo realistic printed fabric graphics. Displays can be straight, curved or arced to create impressive seamless graphic walls. Milans can also be combined with the latest cutting edge technology of our Vision Lightscreens and Touchscreens. The perfect solution for marketing and communications at your next tradeshow, exhibition or event.

### Features

- Portable and assembled in under 8 minutes
- Modular design allows a wide range of size options & conversion to other sizes
- Single and double-sided graphics available
- Precision engineered lightweight components
- Simple push button connectors for fast assembly
- Custom solutions available
- Made from recyclable materials

### Accessories

- Your choice of counters
- Powerful LED downlights equivalent to 150 W halogen output
- Travel bags
- Rotomoulded Slimline Case
- Case to counter conversion kit

## FlatWall

### 3 Standard Widths

#### 8 ft. FlatWall

Dimensions: 88" x 88"  
Weight: 27 lbs

#### 10 ft. FlatWall

Dimensions: 115" x 88"  
Weight: 29 lbs

#### 20 ft. FlatWall

Dimensions: 229" x 88"  
Weight: 39 lbs

Custom sizes available

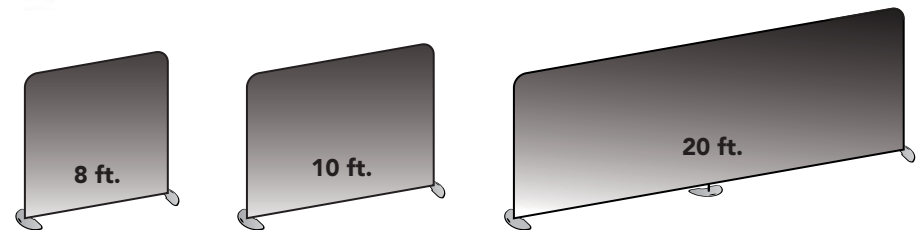

## Curve

### 3 Standard Widths

#### 8 ft. Curve

Dimensions: 94" x 88"  
Weight: 27 lbs

#### 10 ft. Curve

Dimensions: 114" x 88"  
Weight: 29 lbs

#### 20 ft. Serpentine

Dimensions: 228" x 88"  
Weight: 48 lbs

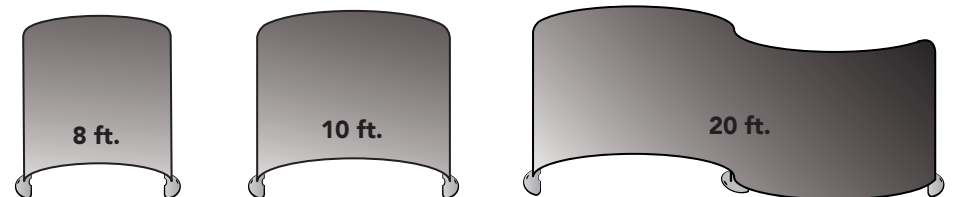

# D5 MILAN

## Arc

### 2 Standard Widths

#### 8 ft. Arc

Dimensions: 88" x 97.5"  
Weight: 27 lbs

#### 10 ft. Arc

Dimensions: 115" x 97.5"  
Weight: 29 lbs



### 5 Style Options

- A. 8 ft. / 10 ft. Arc
- B. 10 ft. Arc + Lightscreen
- C. 10 ft. Arc + Walkthrough
- D. 10 ft. Arc + Kiosk
- E. 10 ft. Arc + Elipse

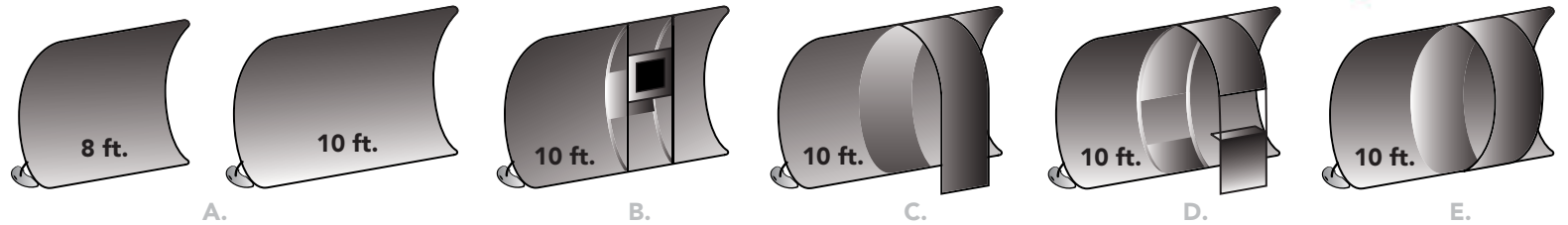

## Shapes

### 4 Standard Sizes

#### 8 ft. Shape

- A. & B. Dimensions: 94" x 88"
- C. & D. Dimensions: 88" x 88"

#### 10 ft. Shape

- A. & B. Dimensions: 114" x 88"
- C. & D. Dimensions: 115" x 88"

Custom sizes available



### 4 Style Options

- A. Curve w. Curve Top
- B. Curve w. Sloping Top
- C. FlatWall w. Wave Top
- D. Star

Custom styles available

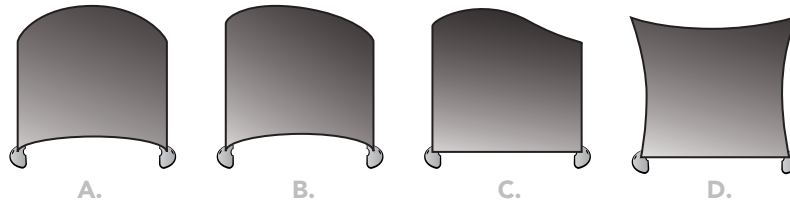

## Table Top

### 4 Standard Sizes

#### FlatWall Table Top

- Dimensions:  
5 ft. 60" x 36" / 60" x 48"  
6 ft. 72" x 36" / 74" x 48"

#### Curve Table Top

- Dimensions:  
5 ft. 62" x 36" / 62" x 48"  
6 ft. 74" x 36" / 74" x 48"



### 2 Style Options

- A. FlatWall Table Top
- B. Curve Table Top

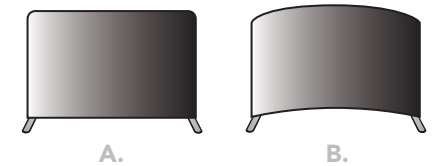

# BLIZZARD



4 x 3 w. side panel

2 x 3

2 x 2

## Big Impression in a Snap

The Poly-printed fabric is attached with Velcro and can be left on the frame. When the frame is unfolded, the graphic stretches smooth. This billboard-in-a-bag folds away into a soft carry bag. Perfect for trade shows, new product launches, event marketing or virtually anywhere you need to make a big statement.

- Lightweight for easier transport
- The graphic stays on even when folded down
- Simple and fast assembly and graphic change
- Cost effective – big exposure

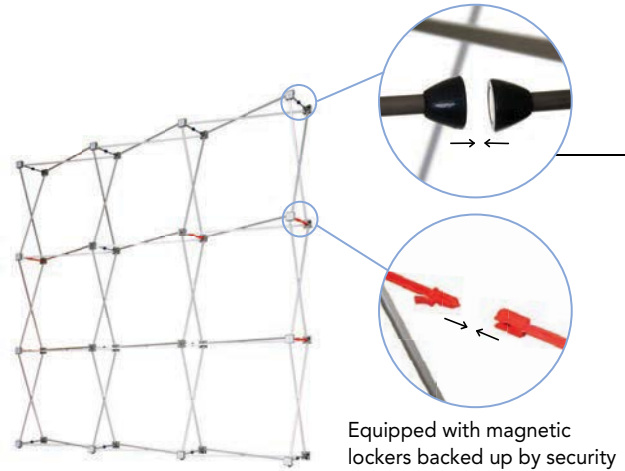

Equipped with magnetic lockers backed up by security hooks for a reliable solution.



### Easy to change graphics

With Velcro-fastened graphics, changing the message could not be easier.

## Blizzard

### Graphic Sizes:

**2 x 2:** 59" x 59"

**2 x 3:** 59" x 88"

**3 x 3:** 88" x 88"

**4 x 3:** 116.5" x 88"

Side panels: 11.5" in width

### Packed Weights:

**2 x 2:** 15.3 lbs

**2 x 3:** 22.7 lbs

**3 x 3:** 24.4 lbs

**4 x 3:** 28.2 lbs

\* Packed weight incl. graphics, bag & box

### Easy travel options

Half Oval Case

Full Oval Case

Nylon bag

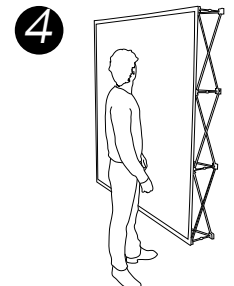
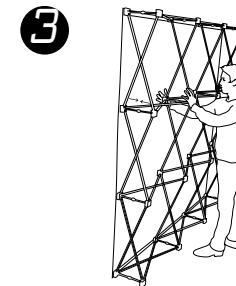
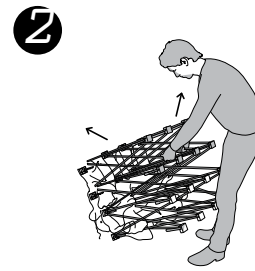



# TRADEWIND

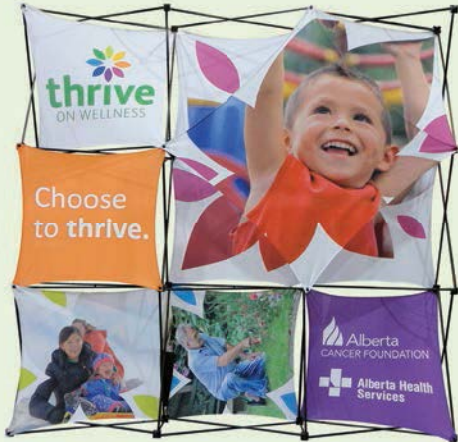

3 x 3



4 x 3

## Flexible Imaging Systems

The TradeWind system leads the way in portable displays. This multi-panel tension fabric display offers exhibitors virtually limitless possibilities. TradeWind allows you to create a 3-D environment with front and back graphics that allows for stunning visual impact.

TradeWind is a lightweight system, which maximizes versatility and visual impact. Its sleek, compact design and quick set-up make TradeWind a revolutionary advancement in the display industry.

Take the opportunity to place a shelf on one of the sections and TradeWind not only highlights your message but also shows off your lighter weight products.



### Magnetic solution

Magnetic connector extrusions on middle hubs will engage opposing hubs to lock frame in expanded position.



### Easy travel options

Half Oval Case

Full Oval Case

Nylon bag



## TradeWind

### Dimensions:

- 2 x 2:** 59.5" x 59.5", 6 lbs
- 2 x 3:** 59.5" x 88.5", 8 lbs
- 3 x 3:** 88.5" x 88.5", 12 lbs
- 4 x 3:** 117.5" x 88.5", 18 lbs

\* Weight is shown as frame weight

### Graphic Sizes:

- 1 x 1:** 29.25" x 29.25"
- 1 x 2:** 29.25" x 58.5"
- 1 x 3:** 29.25" x 87.75"

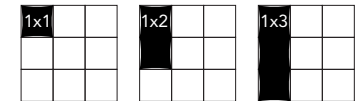

- 2 x 2:** 58.5" x 58.5"
- 2 x 3:** 58.5" x 87.75"

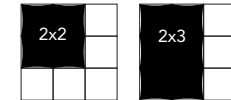

- Small Diamond:** 41.375" x 41.375"
- Large Diamond:** 58.5" x 58.5"

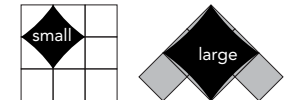

# TYPHOON



4 x 3 Straight

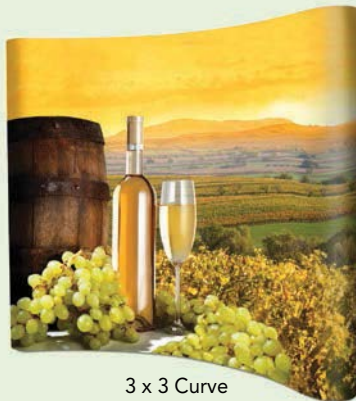

3 x 3 Curve

## A Wonder Wall of Great Design

Capture your customer's attention with this elegant pop-up display mural. The curves create a sleek contoured look that stands out among crowds.

Its versatility, ease of set up and professional look make the Typhoon pop-up display the perfect choice for your next tradeshow exhibit or marketing event.

- New generation of Pop-Up utilizing stronger and lighter materials
- Can be used as single or double sided
- Available in various widths and as curved or straight



### Magnetic solution

The magnetic system provides for quick and easy assembly.



### Easy travel options

The complete unit incl. accessories easily fits in a transport case.  
(Transport case or carrying bag not included)



## Typhoon

### Dimensions:

#### Straight

- 2 x 3: 78" x 89", 17.4 lbs
- 3 x 3: 106" x 89", 29 lbs
- 4 x 3: 135" x 89", 34.8 lbs

#### Curve

- 2 x 3: 76" x 89", 17.4 lbs
- 3 x 3: 100" x 89", 29 lbs
- 4 x 3: 122" x 89", 34.8 lbs

\* Packed weight incl. graphics, bag & box

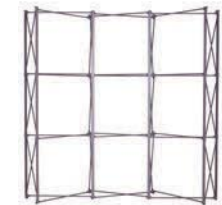

3 x 3 Curve

Typhoon include structure and foldable magnetic bars, top and bottom strips for the graphic panels.

1

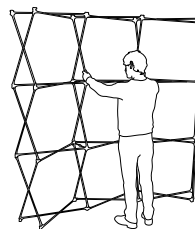

2

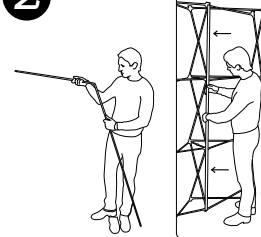

3

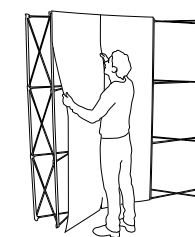

4

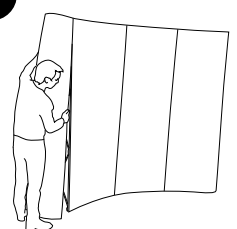

# MISTRAL



## Easy Come. Easy Go

The Mistral roll-up banner stand is cleverly compact and convenient. Its ease of set up, portability and economical design make the Mistral an industry standard for exhibit, retail and professional environments.

- Set up in seconds
- Lightweight
- Stable base

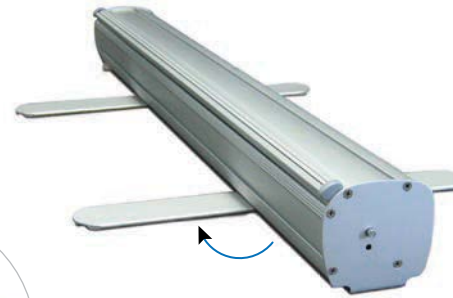

## Mistral

**Width:**  
33.5

**Heights:**  
79" or 86"

**Packed Weights:**  
7 lbs or 9 lbs

*\* Packed weight incl. graphics & bag*



## Easy travel

With the display comes a compact and durable bag equipped with a shoulder strap.

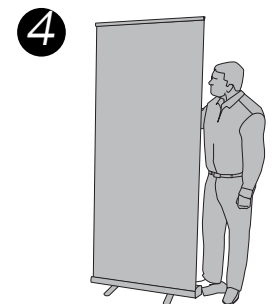



# SIROCCO



## Simply Stylish

The Sirocco roll up banner stand has a distinctive shape and is easily set up. It is often referred to as a retractable that is simply stylish. A great way to differentiate the look of your tradeshow booth, store or any space you wish.

- Modern appearance
- Set up in seconds
- Fast and easy to alter graphics

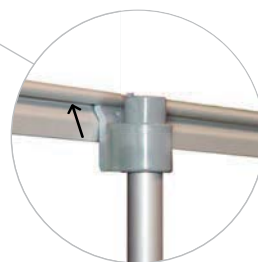

Hook up to the top profile easily by inserting the end of the pole to the slot of the profile.



## Sirocco

**Widths:**  
33.5"

**Heights:**  
79" or 86"

**Packed Weights:**  
11.3 lbs or 13 lbs

*\* Packed weight incl. graphics, bag & box*

## Easy travel

With the display comes a durable bag equipped with a shoulder strap.





## Roll Up with Style and Grace

One of the most graceful and convenient retractable banner stands on the market. Zephyr has a conservative design that lets the message speak for itself. The foot is discreet and the cassette, which protects the message when not in use, is compact.

- The most graceful roll-up system on the market and award winning design
- More branding – less hardware showing
- Adjustable height
- Easy snap profile for attaching graphics



## Zephyr

### Widths:

33.5", 39.4", 49.25" or 59"

### Adjustable Heights:

61" - 86.6"

### Packed Weights:

9.9 - 16.1 lbs

*\* Packed weight incl. graphics, bag & box*



The materials have been carefully chosen to make the unit light, smart and easy to use.



### Easy travel

With the display comes an attractive and durable bag equipped with a shoulder strap.



1

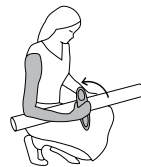

2

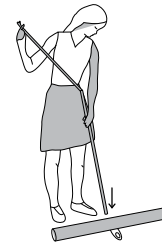

3



4

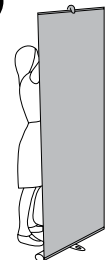

# ALIZE



## Let the Message Speak for Itself

Alize is designed for those who want a usable and easy solution with perfection in every aspect. The materials are carefully chosen to keep low weight and achieve a high usability. The stylish and unique design of the foot makes this product stable and exclusive.

- Ground breaking shape and form
- The solution provides maximum focus on the message
- Easy snap profile for attaching graphics
- Simple and lightweight



Uniquely designed foot  
in highest quality

## Alize

### Widths:

23.625", 31.5", 33.5" or 39.4"

### Heights:

77", 85", 93.3"

### Packed Weights:

8.2 - 9.7 lbs

*\* Packed weight incl. graphics, bag & box*

### Easy travel

With the display comes an attractive and durable bag equipped with a shoulder strap.

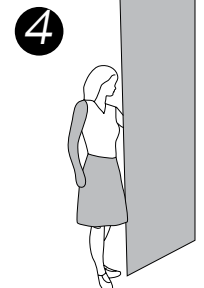
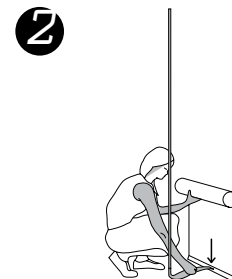
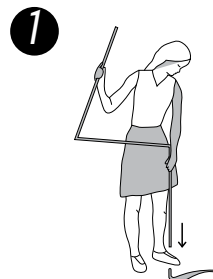

# TWISTER S10

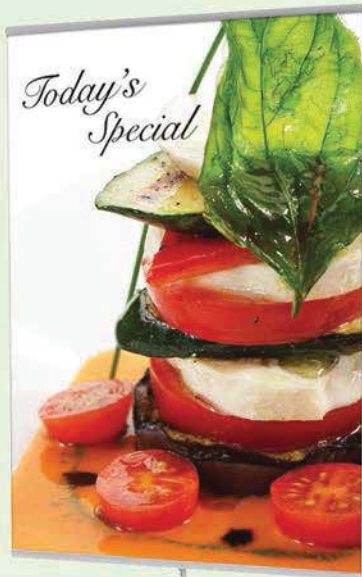

## Empower Your Message

The Twister S10 is a display that enhances and empowers your message. With its unique folding foot, the display is elegant and has great stability. Discreet snap profiles make it easy to change the image.

- One of a kind design
- Telescopic pole for adjustable height
- Available in single & double sided configurations
- Easy snap profile for attaching graphics



Add the double-sided clip to make a double-sided graphic.



Spring-loaded foot makes the unit very balanced.

## Twister S10

### Widths:

23.625", 31.5", 33.5" or 39.4"

### Adjustable Heights:

61" - 86.6"

### Packed Weights:

8.2 - 9.7 lbs

\* Packed weight incl. graphics, bag & box



### Easy travel

With the display comes an attractive and durable bag equipped with a shoulder strap.

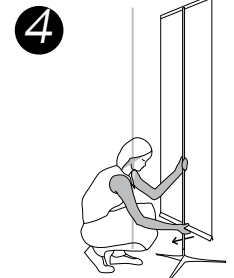
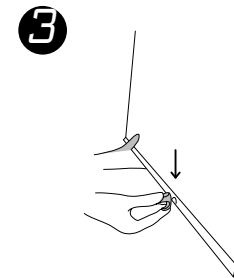
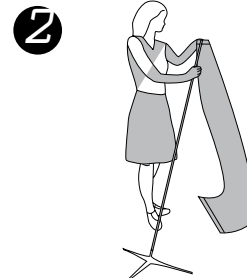
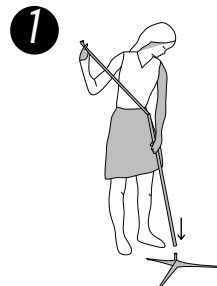



# TWISTER S20

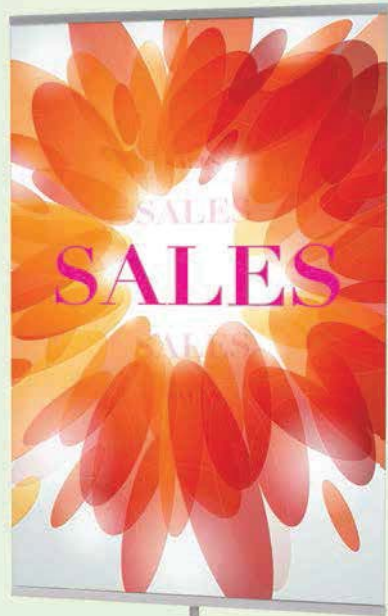

## Supports Your Message Twice

The Twister S20 is extremely user friendly. Arrange the tripod by simply placing it on the ground. Adjust the telescopic pole and mount the image.

- Double-sided exposure
- Simple and versatile
- All-in-one solution
- Telescopic pole for adjustable height
- Easy snap profile for attaching graphics



This Tripod creates a very stable solution.

## Twister S20

### Widths:

23.625", 31.5" or 39.4"

### Heights:

41" - 78.75"

### Packed Weights:

5.1 - 8.4 lbs

*\* Packed weight incl. graphics, bag & box*



### Easy travel

With the display comes an attractive and durable bag equipped with a shoulder strap.

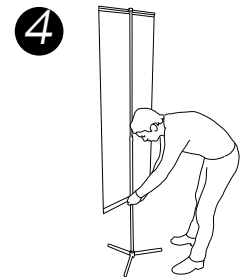
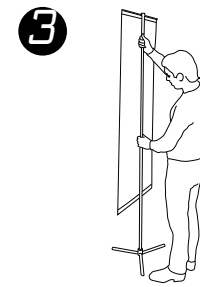
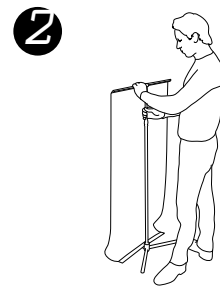
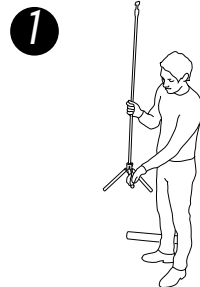

# SPIRIT



## Go Clean. Go Green

The Spirit banner stand is one of the most environmentally friendly display solutions on the market. Made from managed growth Bamboo, this free standing banner display is extremely lightweight and versatile. Simple and very fast graphic changes also make them ideal for use in exhibit and retail environments.

- Environmentally friendly
- Lightweight
- Easy set up
- Eco Gold Standard fabrics available

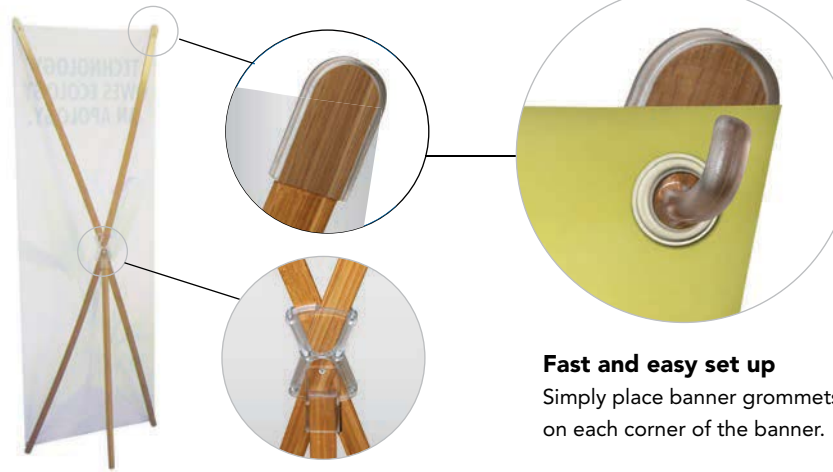

### Fast and easy set up

Simply place banner grommets on each corner of the banner.

## Spirit

**Widths:**  
23.375"

**Heights:**  
69.375"

**Packed Weights:**  
3.25 lbs

*\* Packed weight incl. graphics, bag & box*

### Easy travel

With the display comes an eco-friendly bag with a Velcro closure.

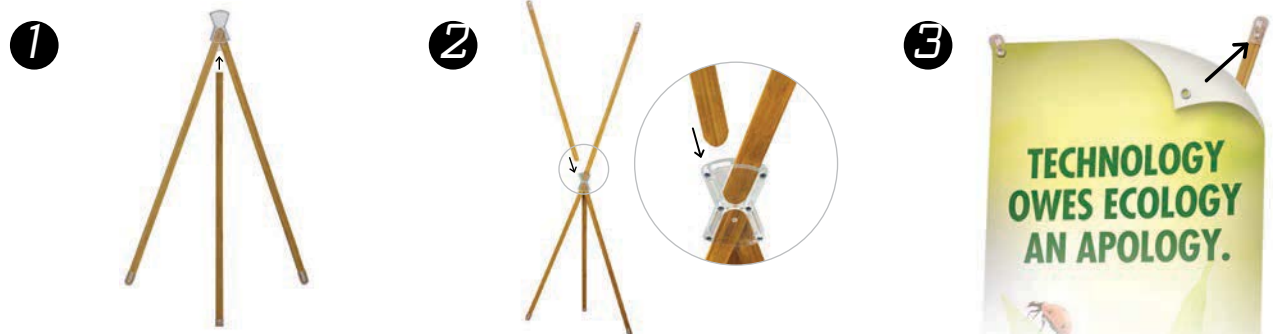

# D4 DISPLAYS

## Versatile Display Systems

D4 Displays is a freestanding portable banner system available in a wide range of graphic sizes. Banners can be either straight or curved. Displays can be used individually, in groups, or linked together to create graphic walls. The ideal choice for marketing and communications at exhibitions, conferences and events.

### Features

- Portable and assembled in under 3 minutes
- Simple, elegant design in various size options
- Single and double-sided graphics available
- Displays are stable and can be left unattended
- Combines high strength material with precision engineering
- Integrated light system

### Banner Options

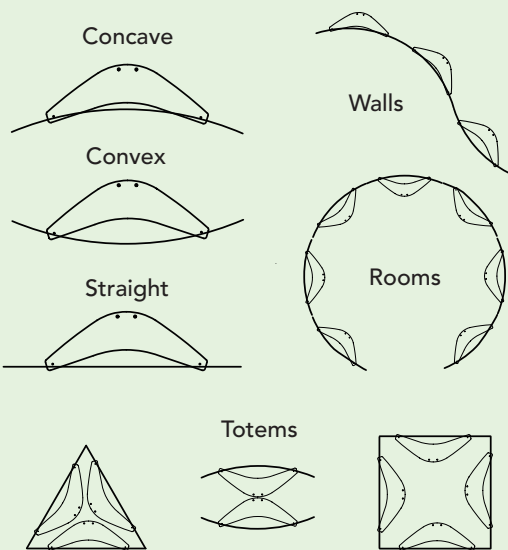

## D4 Standard

Standard displays come in two widths. D4.6 is 24" wide, D4.8 is 32" wide. The D4.6 and D4.8 come in three height options.



## D4 Standard

### 2 Standard Widths

<b>D4.6 T</b>	24" x 42"	10.2 lbs
<b>D4.6</b>	24" x 72"	11.0 lbs.
<b>D4.6 E</b>	24" x 84"	12.0 lbs.
<b>D4.8 S</b>	32" x 72"	16.8 lbs.
<b>D4.8</b>	32" x 84"	17.0 lbs.

\* Weight is shown by packed weight

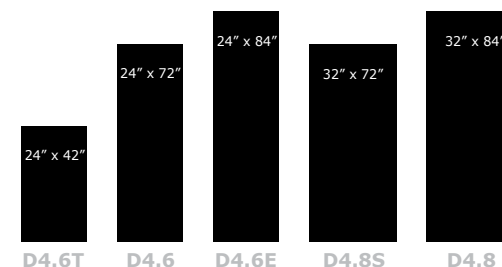

## D4 Wave

A single pair of curved aluminum bars can create both concave and convex displays. Use multiple units to create graphic walls and a variety of shapes.



## D4 Wave

### 2 Standard Widths

<b>D4.6</b>	39" x 72"	10.5 lbs.
<b>D4.6 E</b>	39" x 84"	12.4 lbs.
<b>D4.8 S</b>	48" x 72"	17.2 lbs.
<b>D4.8</b>	48" x 84"	20.1 lbs.

\* Weight is shown by packed weight

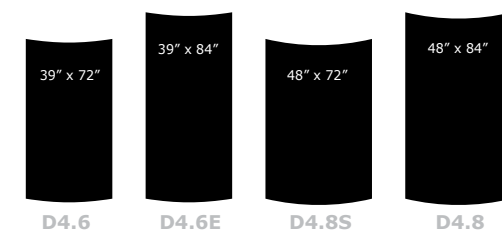



# D4 DISPLAYS

## D4 Linked

Several different linked models can be created by linking standard D4 Displays together using 24", 32" or 48" banners. All linking banners are 1" longer than the side banners at the top and bottom since the linking cross ties are attached above and below the side banners.

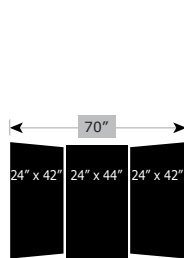

**D4.6-T6**  
6 ft. Table Top Display

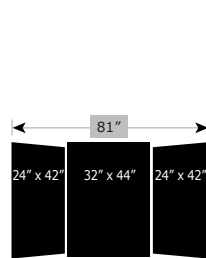

**D4.6-T8**  
7 ft. Table Top Display

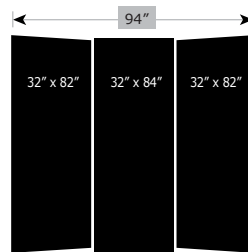

**D4.8-L8**  
8 ft. Booth Display

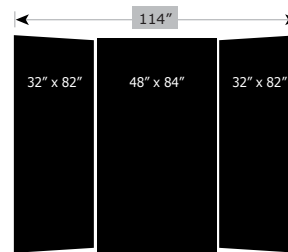

**D4.8-L10**  
10 ft. Booth Display

## D4 Linked

### 4 Standard Widths

<b>D4.6-T6</b>	70" x 44"	18.0 lbs.
<b>D4.6-T8</b>	81" x 44"	18.2 lbs.
<b>D4.8-L8</b>	94" x 84"	41.5 lbs.
<b>D4.8-L10</b>	114" x 84"	42.0 lbs.

\* Weight is shown by packed weight

Flexible.  
Practical.  
Stylish.

### Accessories

- 50 W LV Single or Twin D4 Light Kit – 60 degree beam with UV filter
- Travel bags
- Rotomoulded cases



**D4 LIGHT KIT (Single)**



**D4 LIGHT KIT (Twin)**

**D4.8 Travel Bag**  
37" w x 14" h x 6" d  
4.0 lbs.



**D4.6 Travel Bag**  
32" w x 10" h x 6" d  
2.0 lbs.

**Rotomoulded Wheeled Case**  
16" w x 52" h x 15" d  
13.0 lbs.

**Graphic case**  
51" w x 4" h x 4" d  
2.0 lbs.





# VISION LIGHTSCREEN



Visions Lightscreens come in four standard sizes from 7" x 10" up to 30"x 40". Designed to be cable or wall mounted, combined with our lightweight freestanding display system and incorporate leaflet dispensers and display shelves.

Alternatively our smaller Vision Lightscreens can be used as standalone table top or counter displays.

## Innovative LED Lightbox

The Vision Lightscreen uses innovative low voltage LED technology to create an ultra slim acrylic lightbox that is only 0.25" thick. Images are easily changed and will be enhanced with intense, vibrant colour.



All components are lightweight and of the highest quality, making the displays both portable and durable. The system uses the minimum number of fixings and requires no tools or specialist knowledge for rapid self assembly.

Polished aluminum masts simply slot into a laser cut steel base and are held in position by tension cables. The height of a standard display is 65" and it weighs approximately 16 lbs with all components attached.

Lightscreens come with 10 ft. of power cable, which can be concealed inside the central mast and a standard low voltage plug.

Vision Lightscreen is perfect for corporate lobbies, retail environments, seminars and exhibitions.



## Applications

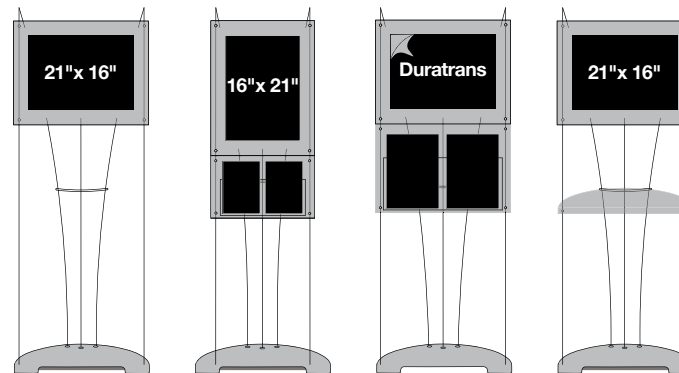

# VISION TOUCHSCREEN



## Multi-functional LCD Multi-media Display

The very latest generation of our extremely popular LCD multi-media displays has many new and exciting features designed to engage and attract your customer's attention.

The Vision Touchscreen offers your customers the opportunity of interaction with your brands and products through its customizable touch panel screens.

The Vision Touchscreen is a completely self-contained multi-media display, which can be paired with a display stand that incorporates a graphic wrap. This can be custom printed to provide additional branding opportunities.

The Vision Touchscreen is lightweight, portable and very stable making it ideal for use within retail, hotel & corporate lobbies, events, seminars as well as trade show environments. In fact anywhere that you want to communicate with your customers.

Depending on location the display can also be used as a counter or tabletop display with its detachable support mount or wall-mounted using a standard monitor bracket. Alternatively our clamp mount enables it to be combined with our D5 Milan fabric wall structures.



Vision Touchscreen can be combined with a range of **literature holders**

## Features



Remote Control

Alternatively for different environments the Touchscreen feature can be turned off for standard remote control operation of the LCD monitor. The Vision Touchscreen operates on a low voltage power supply. The internal drive supports movie, photo, and audio content, loaded on CF Card, SD Card, or USB and programming the Touchscreen panel is achieved with XML software.

- 22" and 32" LCD Digital panel with 16:9 ratio
- 480p, 480i & 720p screen resolution
- Screen rotation for horizontal and vertical modes
- Touchscreen and standard play
- Programmable timing function for unmanned operation
- Selection and creation of play lists
- Supports several file formats:  
Photographic Images - JPEG  
Movies - Divx, AVI, and MPEG2  
Audio - MP3



# BREEZE

## Go with the Wind

Promote your business indoors & outdoors with Breeze displays. Built to last and withstand outdoor weather, while advertising your brand message and attracting crowds.

We carry a variety of Breeze displays, with different bases to choose from depending on your requirements.

The perfect solution for promotional events, shopping malls, retail, store environments, exhibitions and more.

### CROSS BASE (incl. bearing)

- Size: 23.3" x 23.3"
- Weight: 3.1 lbs
- Collapsible steel cross base
- Indoor / outdoor



### Weight Bag (Accessory)

- Diameter: 19.5"
- Weight: 0.41 lbs; 20 lbs (water)
- Plastic, fill with water or sand weight
- Used for extra weight for base

### GROUND STAKE (incl. bearing)

- Size: 2.4" x 23.6"
- Weight: 2.2 lbs
- For outdoor use



## Breeze

### Small

**Flag size:** 1.8' w x 4.3' h  
**Height above ground:** 5.2'

### Large

**Flag size:** 3.6' w x 8.7' h  
**Height above ground:** 11'

### Easy travel

With the display comes a durable bag equipped with a shoulder strap.



# DEMO COUNTER

## Show Off Your Products

The Demo Counter is an attractive curve fronted portable reception, demo and in-store sampling counter designed for easy set up and low cost transportation.

The Demo Counter comes complete with body panel, rigid counter top, base shelf, poles, header panel and light weight carry bag. All the above packs into a single shipping carton and weighs less than 24 lbs.

Made from high quality materials the Demo Counter is available in black or white as standard. Demo Counter can also be produced in special colours when required in larger quantities.

### Easy travel option

With the display comes a nylon bag equipped with a shoulder strap.



## Demo Counter

### With Poles & Header:

31" w x 87" h x 24" d

23 lbs (incl. bag)

### Counter only:

31.25" w x 35.5" h x 24" d

17 lbs (incl. bag)

**Load Bearing Capacity: 75 lbs**

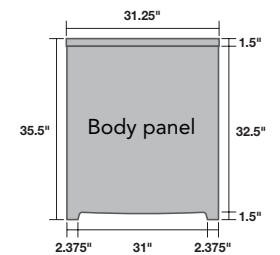
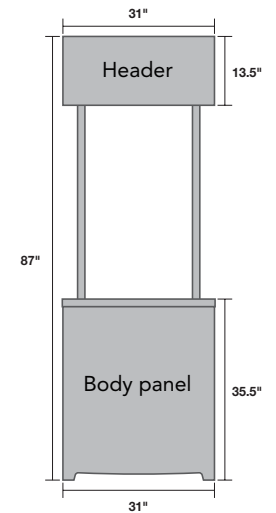



# D5 MILAN PODIUM

## Add Styles to Your Display

The D5 Milan Podium is wrapped with a seamless full colour printed fabric graphic, and comes in a variety of shapes. Made from lightweight aluminum with push button connections, it is extremely strong with a load capability of 200 lbs.

Units have zippered access at back for storage of briefcases, purses, or show materials.

Cable management for iPads, monitors etc. is optional.

### Features

- Lightweight
- Wrinkle free Poly Flex fabric
- Quick set up
- Bottom internal shelf
- Optional Cable management

## D5 Milan Podium

### D-shaped

Dimensions: 30" w x 39" h x 15" d

Weight: 15 lbs

Load Bearing Capacity: 200 lbs



The fabric wrap simply connects with rear zippers.

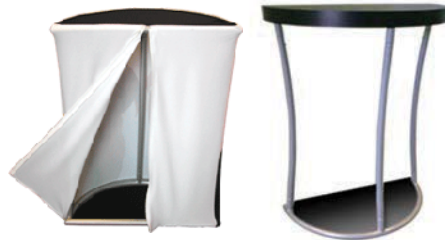

### Rectangular

Dimensions: 30" w x 39" h x 15" d

Weight: 11.2 lbs

Load Bearing Capacity: 125 lbs



### Tapered

Dimensions: 22" w x 38" h x 14" d

Weight: 11.2 lbs

Load Bearing Capacity: 125 lbs



# BLIZZARD COUNTER



## Convenient and Powerful

The Blizzard Counter is the practical starting point for all marketing activities. The printed fabric wraps around the frame, and at the back there is access to two shelves which are ideal for storing brochures and personal items. Combine with your choice of any of our displays for a full showcase solution.

- Fabric graphic to match fabric backwall displays
- Lightweight and easy set-up
- Internal shelves provide storage
- Three different colored table-tops available
- Optional transport bag on wheels

## Blizzard Counter

### Dimensions:

41.75" w x 40" h x 15.75" d  
(Side panels included)

### Packed Weight:

35 lbs

\* Packed weight incl. graphics, bag & box



### 3 color options for top shelf

Blizzard Counter comes with 2 inner shelves and a top shelf.



### Easy travel option

With the display comes a wheeled travel bag equipped with pop-up handle and shoulder strap.

1



2

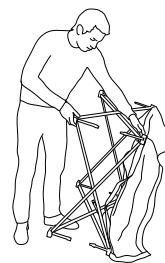

3

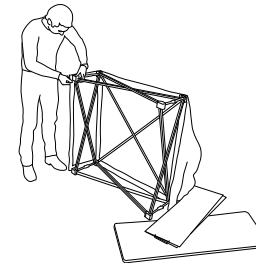

4

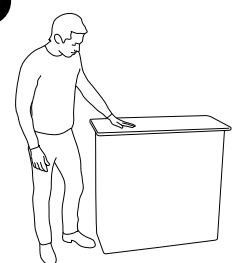

# HANGING SIGNS

## Stand Above the Crowd

All of our hanging signs are made from recyclable aluminum with push button connectors and standard allen bolts for simple assembly.

### Features

- Double Hanging
- Rotating
- Tapered
- Front Lit or Back Lit
- Single or Double Sided
- Straight or Curved

### Shapes

Don't see a style or shape that meets your design requirements? Get in touch and see how we can custom tailor your needs.

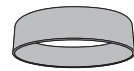

HALO

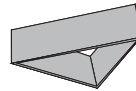

TRIANGLE

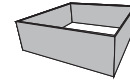

SQUARE

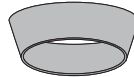

TAPERED HALO

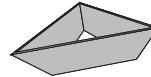

TAPERED TRIANGLE

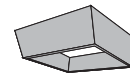

TAPERED SQUARE

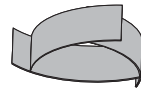

PINWHEEL

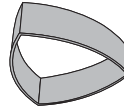

CURVED TRIANGLE



